

VII. Explosion diagram

1. Hand lever

Number	Name	Quantity
1	Locating tab	1
2	Elastic pin $\text{Ø}4 \times 32$	2
3	Roller	1
4	Elastic pin $\text{Ø}4 \times 20$	1
5	Elastic pin $\text{Ø}6 \times 32$	1
6	Elastic pin $\text{Ø}4 \times 20$	1
7	Knob	1
8	Tension bar	1
9	Handle	1
10	Chain	1
11	Pin	1
12	Eyelet bolt	1
13	Lock nut	1

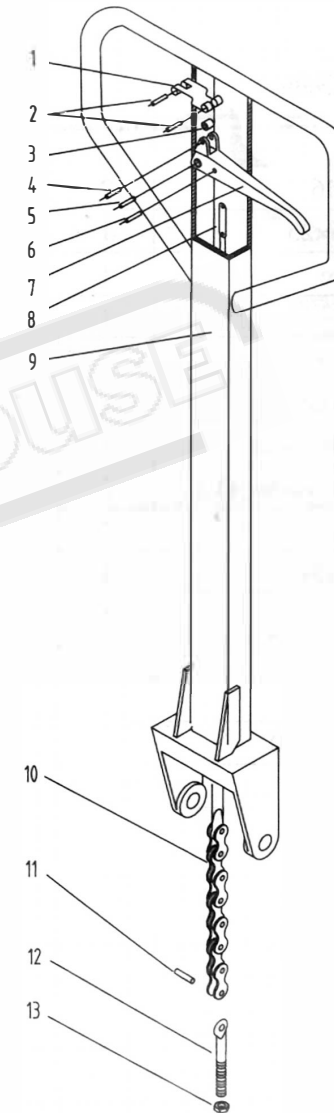

2. Jack:

Number	Name	Quantity
1	Hex nut M6	2
2	Screw M6×25	1
3	Lever plate	1
4	Striker	1
5	O ring Ø4.87×1.8	2
6	Striker spring	1
7	Striker valve seat	1
8	Combined washer Ø20	2
9	O ring Ø12.5×2.65	2
10	Steel ball Ø8	1
11	Bolt M8×50	1
12	Nut M8	1
13	Pin Ø3×15.7	1
14	Valve seat 1000	1
15	Steel ball Ø5	1
16	Pin	1
17	Valve seat spring	1
18	Combined washer Ø10	1
19	Bolt	1
20	Combined bushing 1220	1
21	Combined bushing 2017	2
22	Compressed frame	1
23	Elastic pin Ø4×24	1

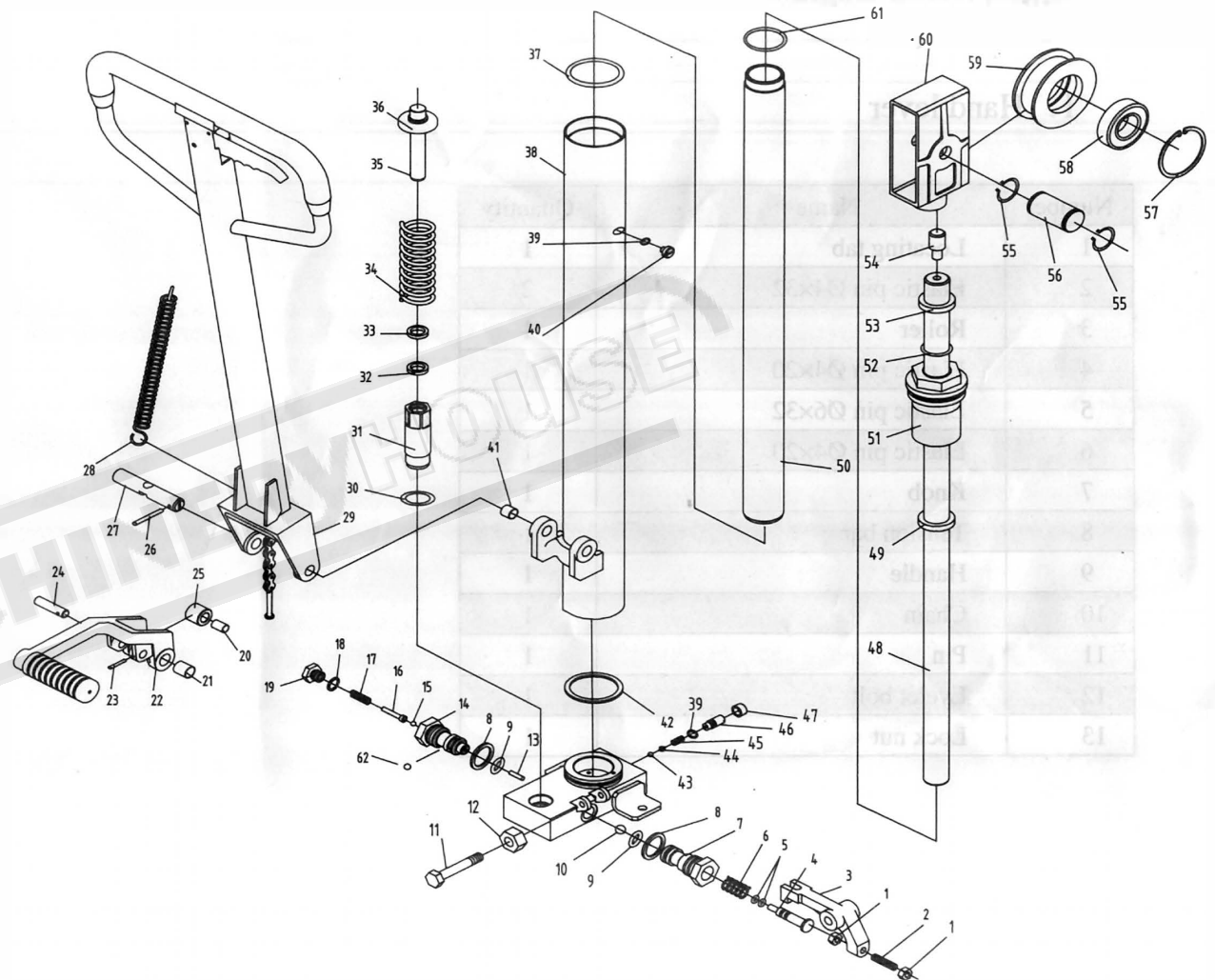

MPS-1000 Manual

Number	Name	Quantity
24	Axle with a hole	1
25	Pinch roller	1
26	Elastic pin Ø5×35	1
27	Compressed frame bearing pin	1
28	Tension spring	1
29	Hand lever	1
30	O ringØ22.4×2.65	1
31	Pump cylinderØ16	1
32	Seal ring Ø16	1
33	Dust proof ring Ø16	1
34	Large spring	1
35	Pump core Ø16	1
36	Large spring seat	1
37	O ring Ø65×3.55	1
38	Cylinder	1
39	O ring Ø7.5×2.65	2
40	Oil plug	1
41	Combined bushing 2012	2
42	Rectangular seal ring	1
43	Steel ball Ø6.5	1
44	Safety valve seat	1
45	Safety valve spring	1
46	Safety valve adjusting screw	1

Number	Name	Quantity
47	Safety valve boot	1
48	Piston rod	1
49	Seal ring Ø31.5	1
50	Oil cylinder	1
51	Top cap	1
52	O ring Ø31.5×3.55	1
53	Dust-proof ring Ø31.5	1
54	Bolt M12×25	1
55	Axial elastic backing ring Ø35	2
56	Chain wheel shaft	1
57	Elastic backing ring for holes Ø72	1
58	Bearing 60207	1
59	Chain wheel	1
60	Chain wheel cover	1
61	O ring Ø47.5×3.55	1
62	Steel ball Ø4	1

3. Fork frame assembly :

No.	Description	Qty.
1	Locking screw M16×50	4
2	Steel ball Ø19	4
3	Bearing 60207	4
4	Axial elastic backing ring Ø35	4
5	Large pulley	4
6	Fork frame	1
7	Forks	2

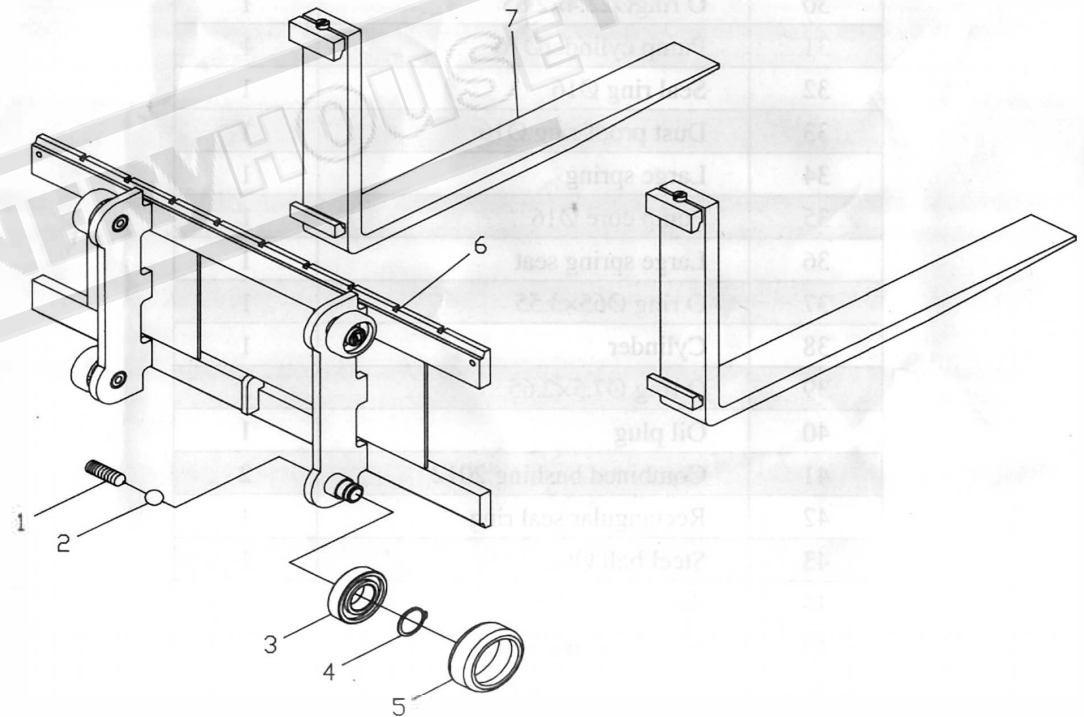

4. Final assembly:

Number	Name	Quantity
1	Universal wheel	2
2	Hex nut M10	8
3	Washer Ø10	28
4	Hex bolt M10×25	8
5	Supporting plate	2
6	Hex bolt M12×25	4
7	Wheel fork	2
8	Front wheel pin	2
9	Axial elastic backing ring Ø20	4
10	Front wheel	2
11	Bearing 60204	4
12	Spring washer Ø10	16
13	Hex bolt M10×35	16
14	Support bar	2
15	Washer Ø12	12
16	Spring washer Ø12	12
17	Hex nut M12	4
18	Hex bolt M12×35	8
19	Hex nut M16	6
20	Screw rod	2
21	Chan box	2
22	Split pin Ø2	2
23	Lock0nutM10	2
24	Screen-cover	1
25	Fork frame assembly	1

Number	Name	Quantity
26	Oil cylinder jacket	6
27	Hexagon socket head cap screws M6×16	6
28	Frame	1
29	Chain	1
30	Lofting jack	1
31	Fixed handle	1

